



CHRISTINE GOLUS
DESIGN

Art Inspired by Above and Below the Garden Soil



Asian-Style Trellis

Media: Bass and balsa wood, fabric, newsprint, small copper nails, brown acrylic paint
Size: approximately 12 inches high x 9.25 inches wide x 5 inches deep



Sections and Chambers
Media: Color pencils

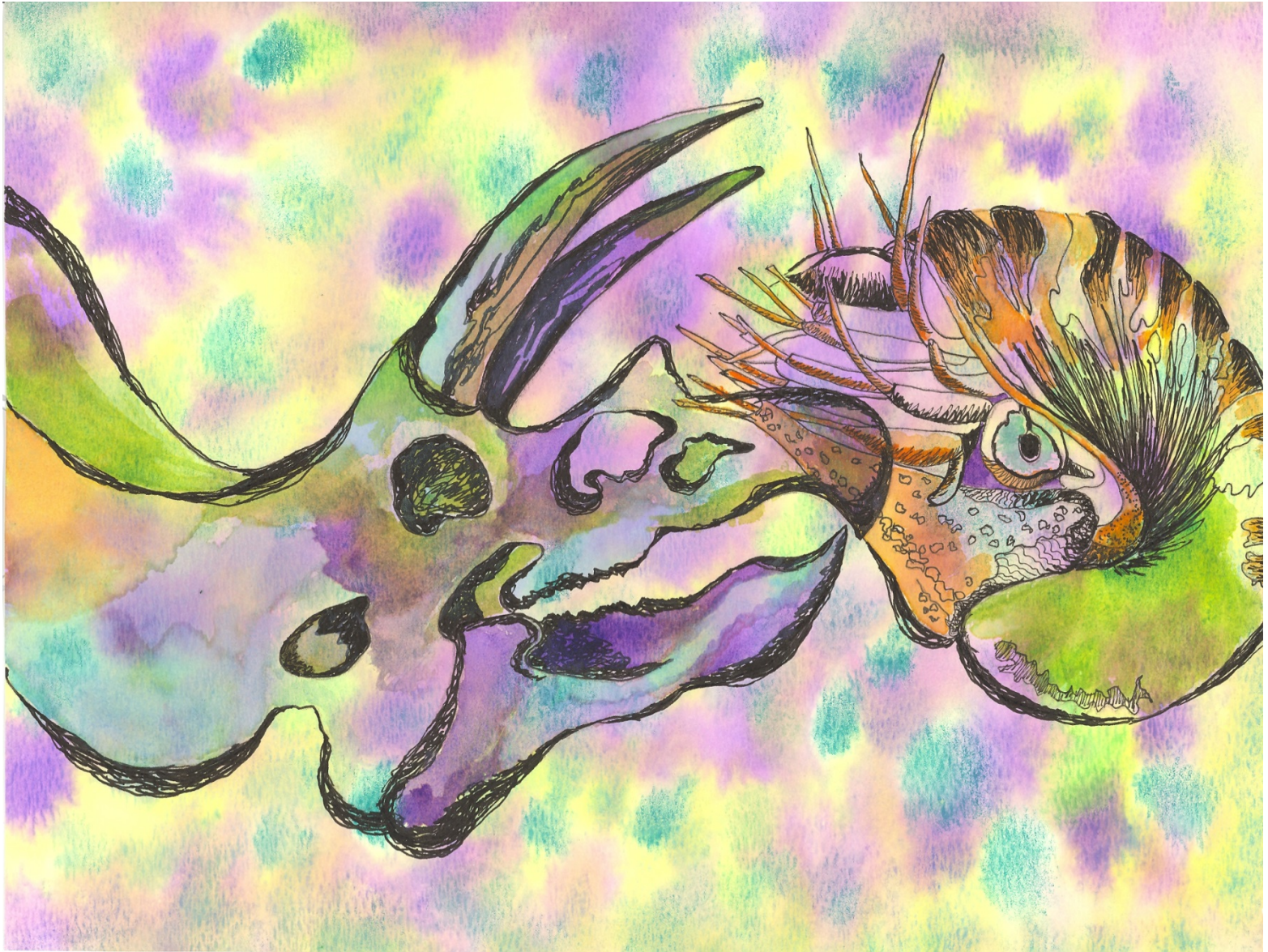

Touching Heads
Media: Ink, watercolor



Dinosaur Shell
Media: Ink, watercolor



Garden Room

Media: Bass and balsa wood structure, store-bought furnishings, fake vine
Size: approximately 9.25 inches high x 11.5 inches wide x 6.25 inches deep

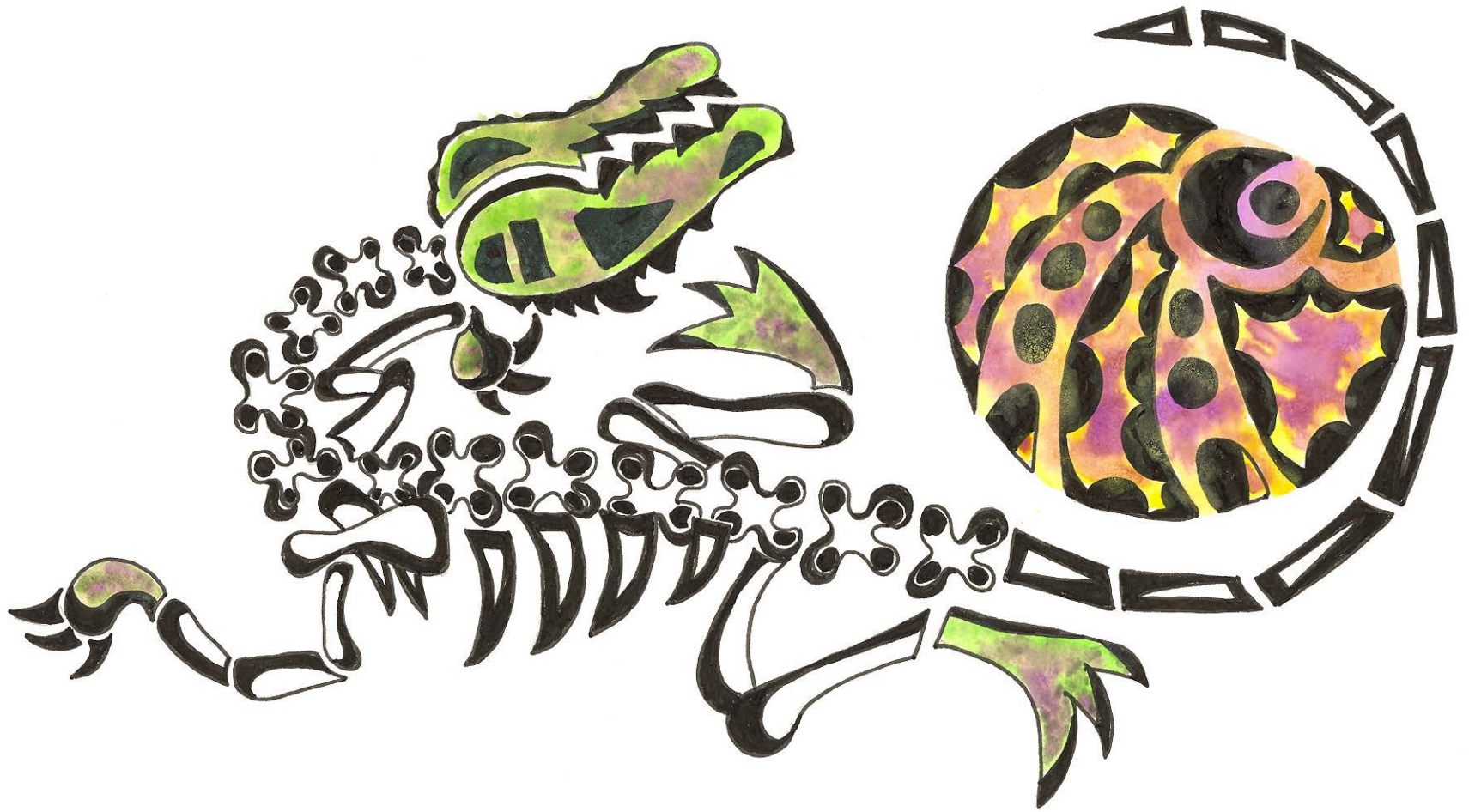

Skeletal Remnants
Media: Ink, watercolor

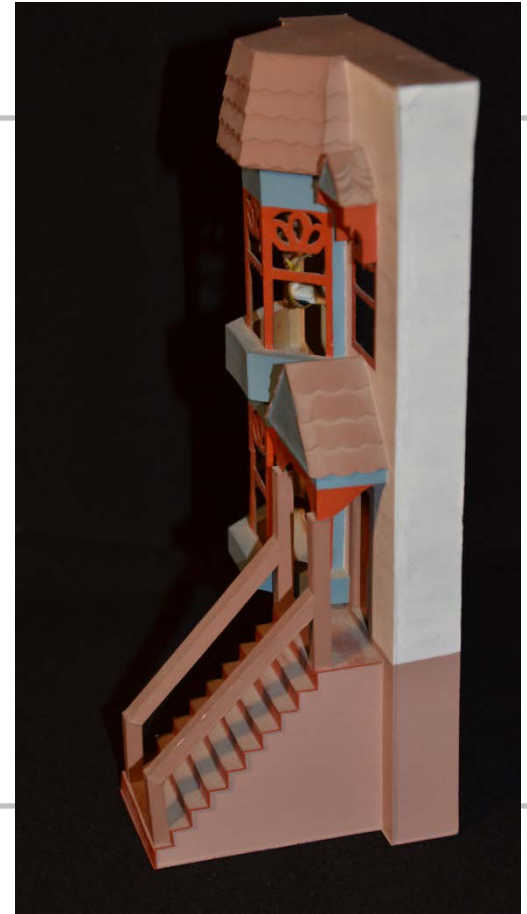











Painted Lady Victorian

Media: paper board, acrylic paint, glass parrot on perch

Size: approximately 10 inches high x 5 inches wide x 1 inch deep

Plant List and Identification
Darcy & Bob Courtyard, 2012

	Camellia (2 each) Specific: Fairy Bloss Camellia (Camellia sasanqua) item 1434		Tuberous begonia (3 each)	
	<i>Arbutus unedo 'compacta'</i> (Strawberry Tree) (1 only)		Vine, non-invasive	
	Azalea (2 each) Specific: Happy Days Azalea		Hydrangea (1 only) Specific: Penny Mac Hydrangea	
	Pittosporum (1 only) Specific: Japanese Pittosporum or Mock Orange or Australian Laurel (Pittosporum tobira)		Clivia Miniata (4 each)	

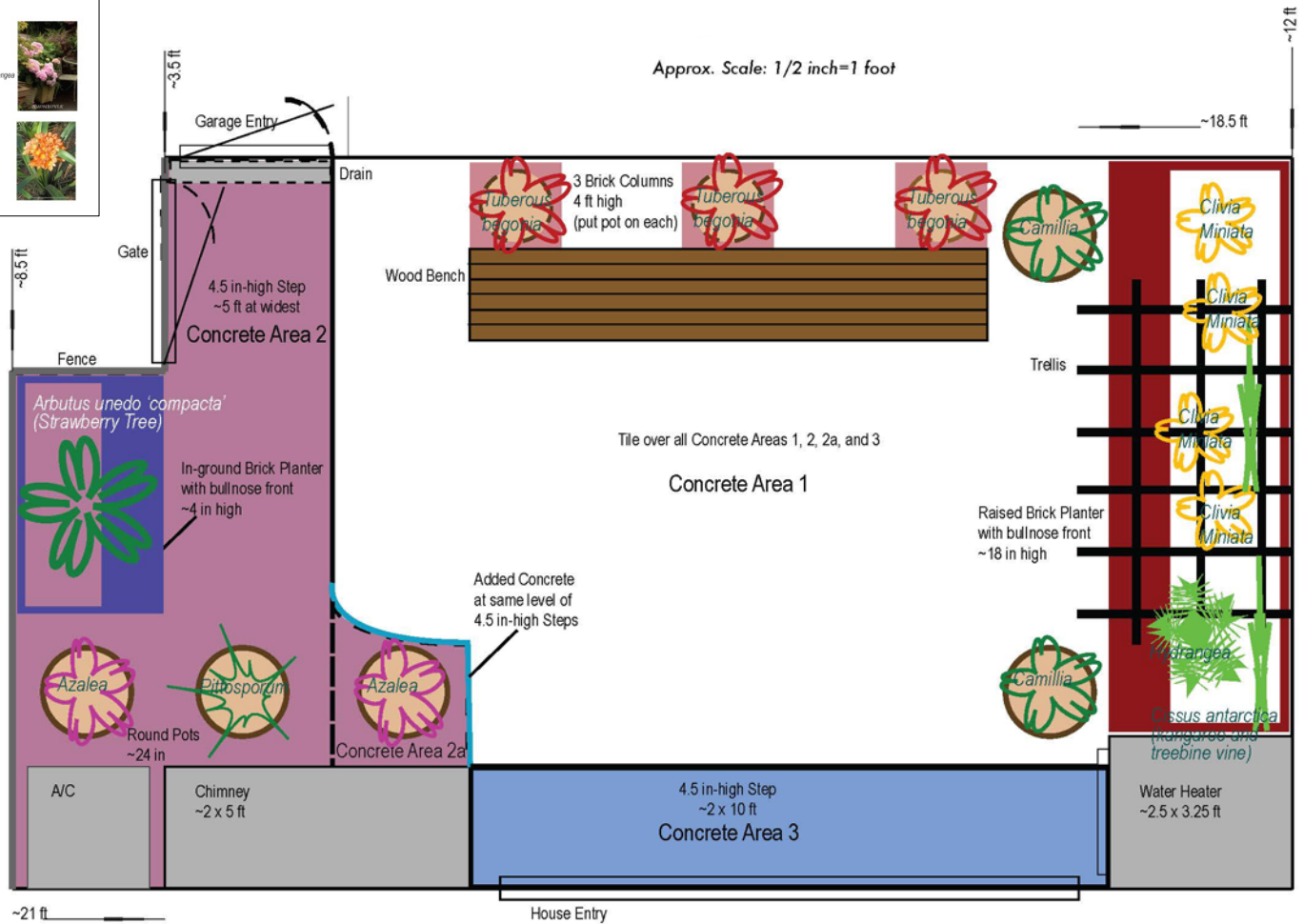

Darcy & Bob's Courtyard Design 2012
Media: Illustrator Rendering and Plant List



Claw and Scallop
Media: Guache

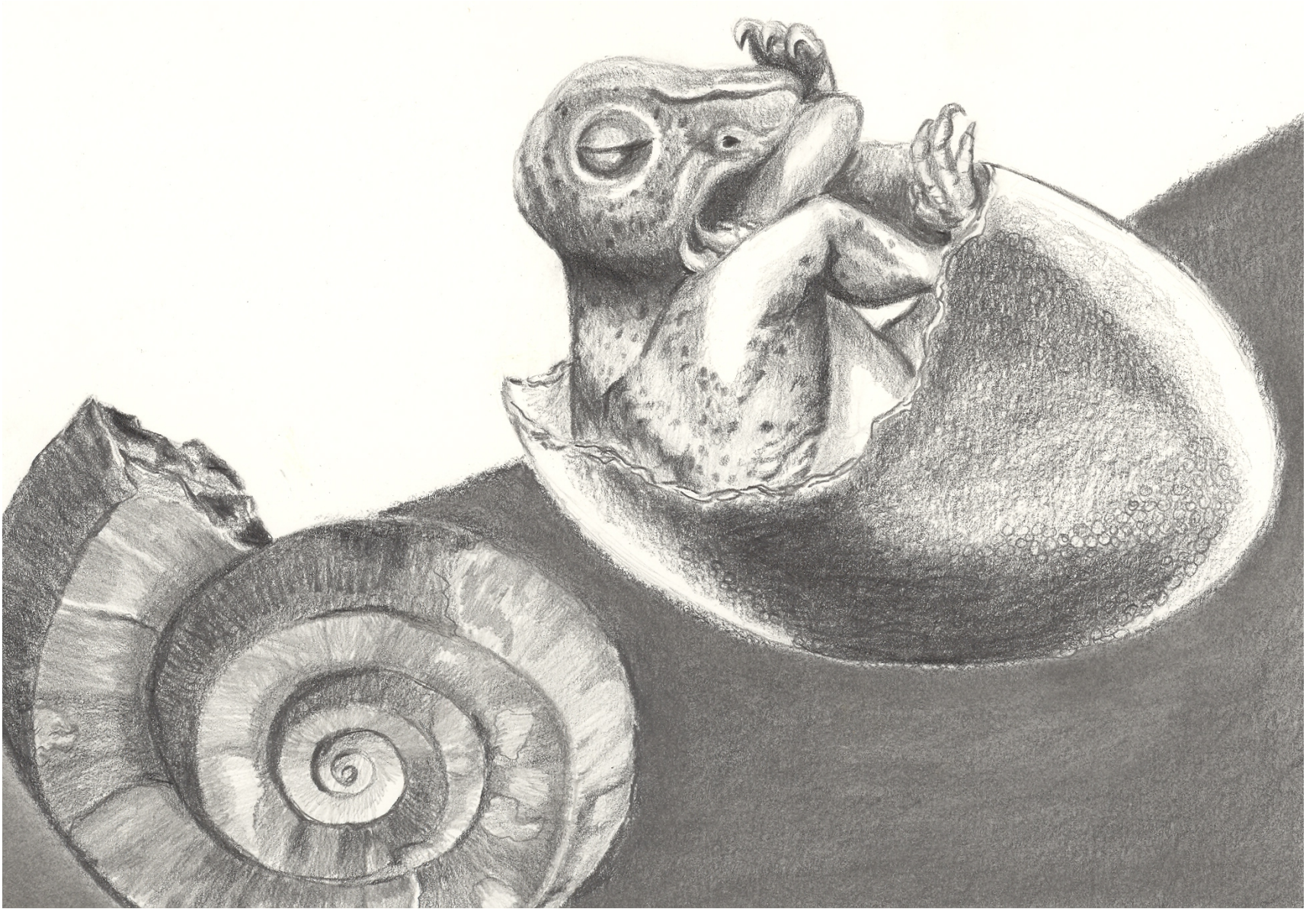

Extinct at Birth
Media: Pencil